

# Minnesota Individual Property Inventory Form



DEPARTMENT OF  
ADMINISTRATION

STATE HISTORIC PRESERVATION OFFICE

Please refer to the *Historic and Architectural Survey Manual* before completing this form.

Must use Adobe Acrobat Reader to complete and save this form. Adobe Acrobat Reader can be downloaded at: <https://get.adobe.com/reader/?promoid=KLXME>

## General Information

Historic Name: \_\_\_\_\_

Other Names: \_\_\_\_\_

Inventory No.: \_\_\_\_\_

Associated MN Multiple Property Form (Name and Inventory No.): \_\_\_\_\_

New or Updated Form: \_\_\_\_\_

Review and Compliance No.: \_\_\_\_\_

Extant: \_\_\_\_\_

Agency Proj. No.: \_\_\_\_\_

Survey Type: \_\_\_\_\_

Grant No.: \_\_\_\_\_

## Location Information

Street Address: \_\_\_\_\_

County: \_\_\_\_\_

City/Twp: \_\_\_\_\_

If Multiple, List All Counties: \_\_\_\_\_

If Multiple, List All Cities/Townships: \_\_\_\_\_

Total Acres: \_\_\_\_\_

USGS 7.5 Quad Name(s): \_\_\_\_\_

Township: \_\_\_\_\_ Range: \_\_\_\_\_ E/W: \_\_\_\_\_ Section: \_\_\_\_\_

QtrQtrQtr: \_\_\_\_\_ QtrQtr: \_\_\_\_\_ Qtr: \_\_\_\_\_

Township: \_\_\_\_\_ Range: \_\_\_\_\_ E/W: \_\_\_\_\_ Section: \_\_\_\_\_

QtrQtrQtr: \_\_\_\_\_ QtrQtr: \_\_\_\_\_ Qtr: \_\_\_\_\_

### Urban:

Subdivision: \_\_\_\_\_

Block(s): \_\_\_\_\_

Lot(s): \_\_\_\_\_

### UTM Coordinates:

Datum: \_\_\_\_\_

UTM Zone	Easting	Northing
----------	---------	----------

_____	_____	_____
-------	-------	-------

_____	_____	_____
-------	-------	-------

_____	_____	_____
-------	-------	-------

_____	_____	_____
-------	-------	-------

_____	_____	_____
-------	-------	-------

_____	_____	_____
-------	-------	-------

Property Identification Number (PIN): \_\_\_\_\_

## Previous Determinations

### Previous Individual Determination:

☐ National Register Listed

☐ NPS DOE

☐ State Register Listed

☐ CEF

☐ SEF

☐ Locally Designated

☐ Not Eligible

### Previous District Determination:

District Name: \_\_\_\_\_

☐ Within a National Register-Listed District

Contributing Status: \_\_\_\_\_

☐ Within a State Register-Listed District

Contributing Status: \_\_\_\_\_

☐ Within a CEF District

Contributing Status: \_\_\_\_\_

☐ Within a SEF District

Contributing Status: \_\_\_\_\_

☐ Within a Locally Designated District

Contributing Status: \_\_\_\_\_

# Minnesota Individual Property Inventory Form

Historic Name: \_\_\_\_\_

Inventory No.: \_\_\_\_\_

Associated MN Multiple Property Form (Name and Inventory No): \_\_\_\_\_

## Classification

Associated Properties (Name and Inventory No.): \_\_\_\_\_

Property Category: \_\_\_\_\_

Number of Resources on the Property:

Buildings: \_\_\_\_ Structures: \_\_\_\_ Sites: \_\_\_\_ Objects: \_\_\_\_

## Function or Use

### Historic:

Function/Use Category: \_\_\_\_\_

Function/Use Category (if other): \_\_\_\_\_

Function/Use Subcategory: \_\_\_\_\_

Function/Use Subcategory (if other): \_\_\_\_\_

### Current:

Function/Use Category: \_\_\_\_\_

Function/Use Category (if other): \_\_\_\_\_

Function/Use Subcategory: \_\_\_\_\_

Function/Use Subcategory (if other): \_\_\_\_\_

## Description

*Provide full Narrative Description on Continuation Sheet.*

Architectural Style: \_\_\_\_\_

Architectural Style (if other): \_\_\_\_\_

Exterior Material: \_\_\_\_\_

Exterior Material (if other): \_\_\_\_\_

## Significance

*Provide full Statement of Significance on Continuation Sheet.*

### Applicable National Register of Historic Places Criteria:

Criterion A: Property is associated with significant events.

☐ Yes ☐ No ☐ More Research Recommended

Criterion B: Property is associated with the lives of significant persons.

☐ Yes ☐ No ☐ More Research Recommended

Criterion C: Property has significant architectural characteristics.

☐ Yes ☐ No ☐ More Research Recommended

Criterion D: Property may yield important information in history/prehistory.

☐ Yes ☐ No ☐ More Research Recommended

Criteria Considerations? ☐ No ☐ Yes

*If yes, describe in Statement of Significance on Continuation Sheet.*

Area of Significance: \_\_\_\_\_

Additional or Other Area(s) of Significance: \_\_\_\_\_

Period(s) of Significance: \_\_\_\_\_

Date(s) Constructed: \_\_\_\_\_

Other Significant Construction Dates: \_\_\_\_\_ *Discuss in Statement of Significance on Continuation Sheet.*

Date Source(s): \_\_\_\_\_

Architect/Builder/Engineer: \_\_\_\_\_

Architect/Builder/Engineer Documentation: \_\_\_\_\_

# Minnesota Individual Property Inventory Form

Historic Name: \_\_\_\_\_

Inventory No.: \_\_\_\_\_

Associated MN Multiple Property Form (Name and Inventory No): \_\_\_\_\_

## Bibliography

*Complete Bibliography on Continuation Sheet.*

## Additional Documentation

For all properties, the following additional documentation must be submitted with the inventory form. Refer to the *Historic and Architectural Survey Manual* for guidance.

1. Photographs
2. Maps

## Preparer's Information and Recommendation

Preparer Name and Title: \_\_\_\_\_

Organization/Firm (if applicable): \_\_\_\_\_

Date Inventory Form Prepared: \_\_\_\_\_

Recommended Individual Evaluation:

- ☐ Eligible for the National Register
- ☐ Not Eligible for the National Register
- ☐ More Information Needed for Evaluation

- ☐ Eligible for Local Designation
- ☐ Not Eligible for Local Designation
- ☐ More Information Needed for Local Designation

Recommended District Evaluation:

- ☐ Within a National Register-Eligible District

Contributing Status: \_\_\_\_\_

District Name: \_\_\_\_\_

District Inventory Number: \_\_\_\_\_

- ☐ Within a Locally-Eligible District

Contributing Status: \_\_\_\_\_

District Name: \_\_\_\_\_

District Inventory Number: \_\_\_\_\_

## State Historic Preservation Office Comments (SHPO Use Only)

Initials: \_\_\_\_\_ Date: \_\_\_\_\_

### Individual Recommendation (NRHP)

- ☐ Concur      ☐ Does Not Concur      ☐ More Information Needed

### Historic District Recommendation (NRHP)

- ☐ Concur      ☐ Does Not Concur      ☐ More Information Needed

### Contributing/Noncontributing Status Recommendation

- ☐ Concur      ☐ Does Not Concur      ☐ More Information Needed

Comments:

### **Narrative Description**

This house faces west on Westervelt Avenue Way W. south of County Road 2 Boulevard. The rectangular plan, one- and one-half-story, gable-roofed building rests on a concrete foundation. The roof is clad in composite shingles and the building exterior is clad in wood shingles. A full-length deck edges the main elevation. This elevation has a variety of windows including single-leaf door flanked grouped double-hung and casement windows. Other windows include double-hung units.

A detached, single-car, gable-roofed garage, also dates from 1952 (Goodhue Co. Assessor). The roof is clad in composite shingles and the exterior in wood shingles.

### **History**

Except for the prominently sited Christ Episcopal Church (1868), there was little development along Westervelt Avenue until after ca. 1940. This house was built during a period when only a few recreational properties were added to the townsite and after most residential development was complete. The builder has not been identified and the site history has not been determined.

### **Statement of Significance**

Included within the boundaries of the Old Frontenac Historic District as listed in the National Register of Historic Properties (NRHP) in 1973 (Lutz 1973), this building appears to be associated with the summer home development that continued through the World-War-II period. However, it is outside the period of significance for recreational properties described in the Old Frontenac Historic District context, "Tourism and Summer Home Development and the 'Lure of Old Frontenac,' 1868-1950" (Zellie and Lucas 2022). Therefore, it is non-contributing to the historic district.

### **Bibliography**

Flies, Bill. *Frontenac Historic District Tour Guide: 160th Anniversary Celebration Edition*. Florence Township Heritage Preservation Commission, 2019.

Foote, C.M. *Plat Book of Goodhue County*. C.M. Foote & Co., Minneapolis, 1894.

Goodhue County, Minnesota. Parcel data accessed at <https://maps.co.goodhue.mn.us/Goodhue%20County%20Tax%20Parcel%20Viewer/>

Lutz, Thomas. "Old Frontenac Historic District." National Register of Historic Places Nomination, 1973.

Wendland, Lorry. *19th Century Frontenac, Minnesota: The Rest of the Story*. Viriditas, Frontenac, Minnesota, 2018 (a).

Wendland, Lorry. *Genealogy of a Village: 19th Century Frontenac, Minnesota*. Viriditas, Frontenac, Minnesota, 2018 (b).

**Minnesota Individual Property** Historic Name: House

**Inventory Form – Continuation Sheet** Inventory No.: GD-FLC-131

Associated MN Multiple Property Form (Name and Inventory No):

---

**Related Project Report:**

Zellie and Lucas, “Old Frontenac Historic District Survey Revision Project.” Submitted to the Florence Township Heritage Preservation Commission and the Minnesota State Historic Preservation Office, 2022.

**Maps**

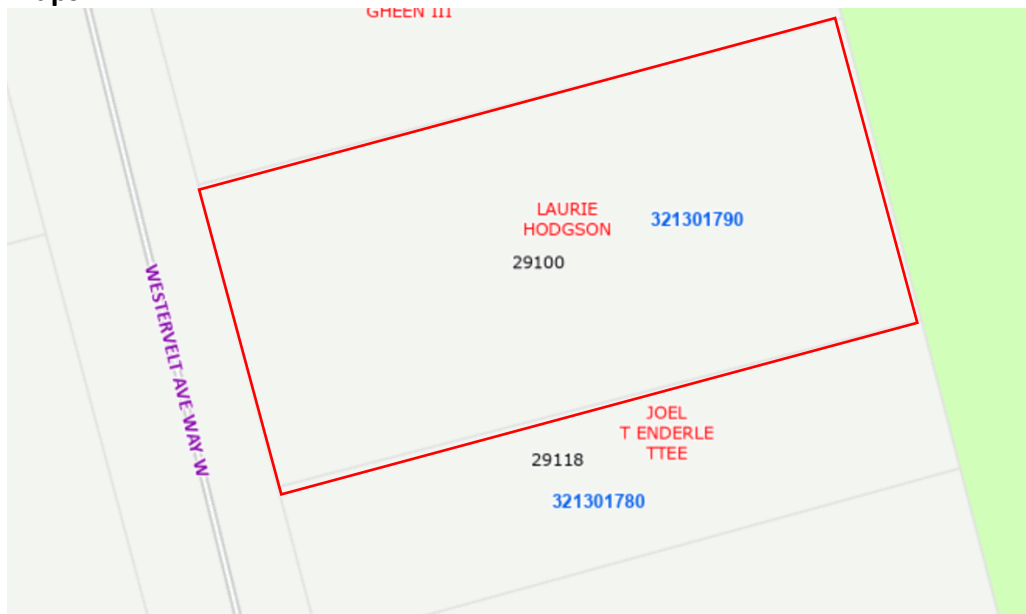

Source: Goodhue County.

**Minnesota Individual Property** Historic Name: House  
**Inventory Form – Continuation Sheet** Inventory No.: GD-FLC-131  
Associated MN Multiple Property Form (Name and Inventory No):

---

**Photographs**



Facing east, Goodhue County Assessor photo, 2019.



Facing east, property sited behind trees as seen from Westervelt Avenue Way, 6/14/2022.