

28589 LAKE AVENUE WAY

321300422

3 Feet

1.25 Acres Valhalla Park-Area 1

321300300

Phase 3 - Cut, stump treat, stack & burn. Late Winter/
Early Spring 2022
Phase 3 - Prescribed Burn Fall 2022
Phase 3 - Seeding with Dry Mesic prairie mix. Late Fall
2022
Phase 3 - IMP through June 30th, 2025

34953 BURR OAK ST

321300441

321300290

302
Feet

118
Feet

117 Feet
0 Feet

34
Feet

43
Feet

202
Feet

322900010

28725 LAKE AVE WAY

321600100

322900050

BURR OAK ST

LAKE AVE WAY
LAKE AVE WAY
LAKE AVE WAY

3.00 Acres Valhalla Park-Area 2

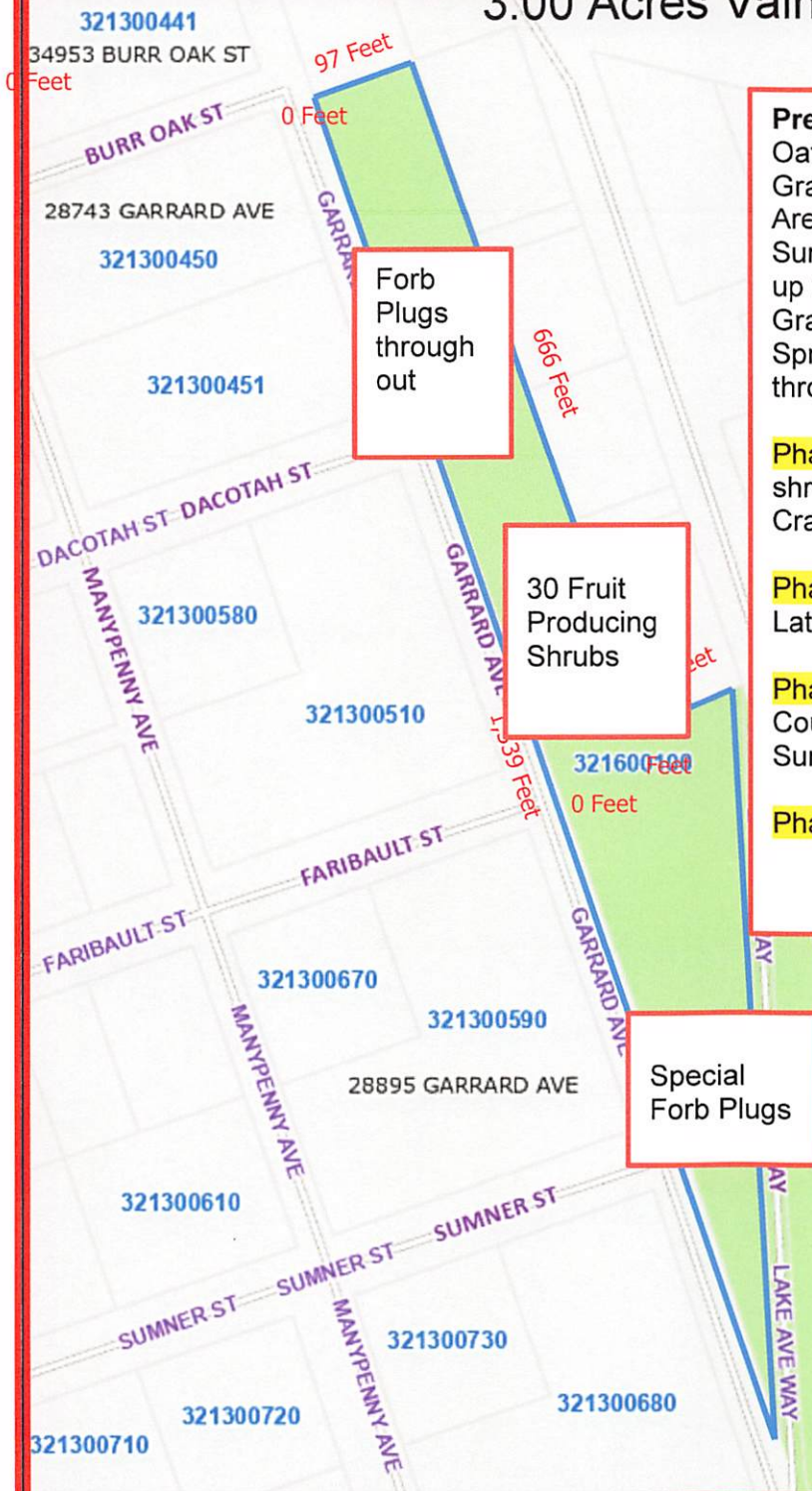

Present: Gooseberry Shrubs, nettles, and Oats from cover crop seeding Summer 2021, Grant 2.
Area has been seeded with Grasses & Forbs Summer 2021. Some are up and more will be up next Spring 2022. Grant 2
Grant 2 – Continue Herbicide Spot Spray/mow and Foliar Spray of invasives through June of 2023.

Phase 3 – Plant 30 Native, fruit-producing shrubs. Gray & Pagoda Dogwoods, Cranberry, Serviceberry. Late Spring 2022

Phase 3 – Plant Forb Plugs (300) Late Spring/Early Summer 2022

Phase 3 – Plant Forbs Plugs thru to the point, County 2 intersection. – Late Spring/Early Summer 2022

Phase 3 – IPM through June 30th, 2025

4.11 Acres Valhalla Park- Area 3

321300510

FARIBAULT ST

321300590

28895 GARRARD AVE

SUMNER ST

321300730

MAINPENNY AVE

321300680

COUNTY 2

321300740

29055 COUNTY 2 BLVD

WELLS ST

321300750

29133 COUNTY 2 BLVD

Seeding & Racking
of Savannah &
Woodland Edge
seed mix. Late
Spring 2022

Present: Milkweed, Wild Bergamot,
Black eyed Susan, Mother's wort, Sweet
Joe Pye weed, Goldenrod, Grasses,
Field Thistle, Purple Meadow Rue, etc

This area needs a Prescribed Burn.
Spring of 2022
Prescribed Burn under Grant 1.

Phase 3 -Cut, stump treat & burn Late
Winter/Early Spring 2022

Phase 3 – Seeding & racking of
Savannah & Woodland edge seed mix.
Late Spring 2022

Phase 3 – Plant trees & shrubs on south
end lower plateau, 15 trees & shrubs-
Hazelnut & Cranberry. Late Spring 2022

Phase 3 – IPM through June 30, 2025

Phase 3 –Prescribed Burn Spring 2025

On the plateau below Lake
Ave, plant Hazelnut and
cranberry trees. Late Spring
2022

0 Feet

LAKE AVE WAY
699 Feet

926 Feet

0 Feet

0 Feet

0 Feet

0 Feet

0 Feet

0 Feet

0 Feet

0 Feet

0 Feet

0 Feet

0 Feet

0 Feet

0 Feet

0 Feet

0 Feet

0 Feet

0 Feet

0 Feet

0 Feet

0 Feet

4.3 Acres Valhalla Park- Area 4 Northern end

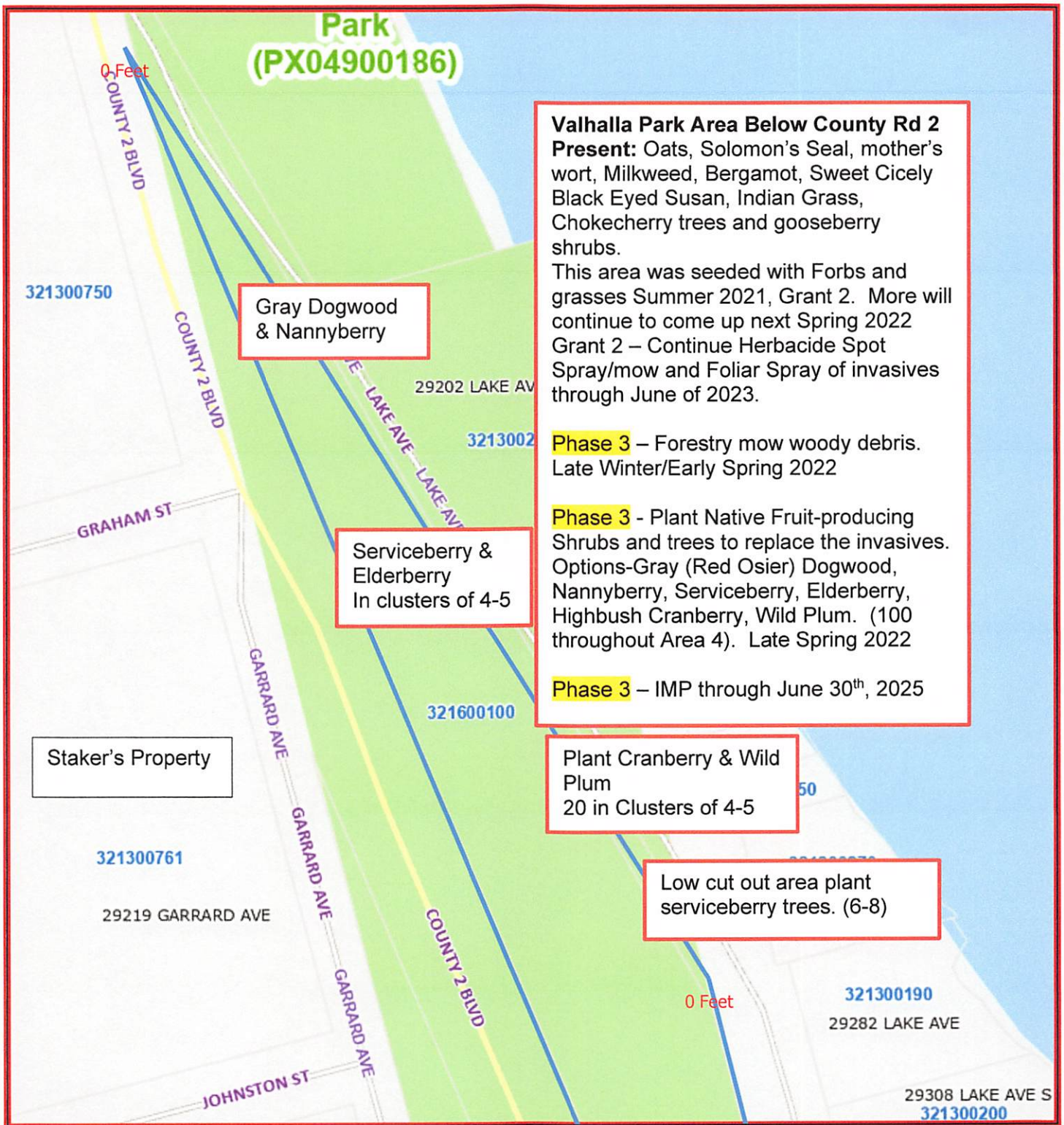

4.3 Acres Valhalla Park-Area 4 Southern end

MEADOW AREA
OF FORBS &
GRASSES

Planting of Wild
Plum & Nannyberry
In clusters of 4-5

Staker's

Valhalla Park Below County Rd 2

Grant 2 – Continue Herbicide Spot
Spray/mow and Foliar Spray of invasives
through June of 2023.

Phase 3 – Forestry mow flat area from
beginning at Johnston St. through to the
SE end of the point

Late Winter/Early Spring 2022

Phase 3 – Plant shrubs & trees Late
Spring 2022 (100 for Area 4)

Phase 3 – IMP through June 30th, 2025

From Barton St. going South to the
point, add low and medium height
shrubs like Highbush Cranberry,
Nannyberry, Hazelnut, &
Elderberry. It is about a 3/4-1 acre
area.

Area above Cty Rd 2 is a
steep slope.

321300820
Gagnon's

Fuglestad's

29369 GA

321300910

321300920

321600100

COUNTY 2 BLVD

LAKE AVE

29282 LAKE AVE

29308 LAKE AVE S

29342 LAKE

321300

29366 LAKE AVE

29402 LAKE AVE

29430 LAKE AVE

29454 LAKE AVE

29460 LAKE AVE

321300180

321300120

321300130

1,765 Feet
COUNTY 2 BLVD

GARRARD AVE

BARTON ST

GARRARD AVE

9 Acres Valhalla Park-Area 5 Northern end

Valhalla Park Area above County 2 Blvd

Very steep and open in some areas

Grant 2 – Continue Herbicide Spot Spray/mow and Foliar Spray of invasives through June of 2023.

Phase 3 – Prep – Brushsaw & remove woody species on steep hillside. Late Winter/Early Spring 2022

Phase 3 – Seeding of stabilization mix & Dogbane plugs on the steep slope. Late Spring/Early Summer 2022

Phase 3 – IPM through June 30th, 2025

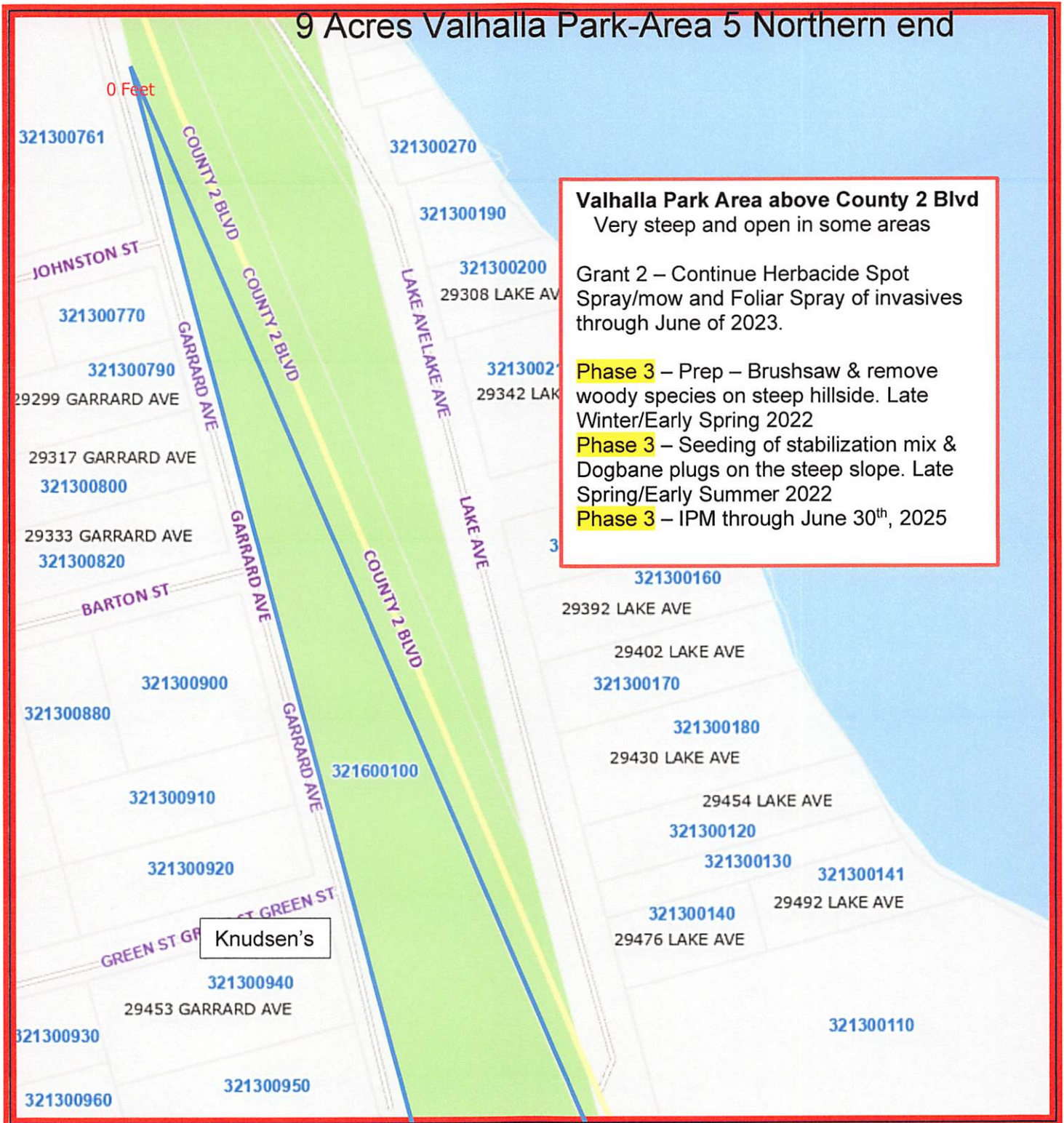

9 Acres Valhalla Park-Area 5 Southern end

29454 LAKE AVE

321300910 321300920 321300940 321300950 321600020 321600100 321600120 322800010 321300130 321300141 321600130 320120100

GARRARD AVE 2,179 Feet

GREEN ST- GREEN ST GREEN

29453 GARRARD AVE

29505 GAR

29604 W

WOOD AVE- WOOD AVE

COUNTY 2 BLVD

LAKE AVE

WOOD AVE

245 Feet

3 Fe

Valhalla Park Area above County 2 Blvd

Steep slope and open in some areas on Northern end

Southern end dense forest with heavy buckthorn.

Grant 2 – Continue Herbicide Spot Spray/mow and Foliar Spray of invasives through June of 2023. (Northern end)

Phase 3– Brushsaw & remove woody invasive Northern Area 5. Late Winter/Early Spring 2022

Phase 3– Seeding of native stabilization seed mix & plugs of Dogbane on the steep slope of the Northern end Area 5. Late Spring/Early Summer 2022

Phase 3– Cut, stump treat, stack and burn woody invasive in the Southern Area 5 to Wood Ave. Late Winter/Early Spring 2022

Phase 3 - Prescribed Burn. Fall 2022

Phase 3– Woodland edge seed mix on outer 2 acres of Southern end. Late Fall 2022

Phase 3– IPM through June 30th, 2025

Phase 3- Remove Woody Invasives to the end of Area 5 to Wood Ave

Woodland edge seed mix on outer 2 acres.

Phase 3– IPM through June 30th, 2025

Woodland edge
seed mix on outer
2 acres.